

Size of solar panels in mm

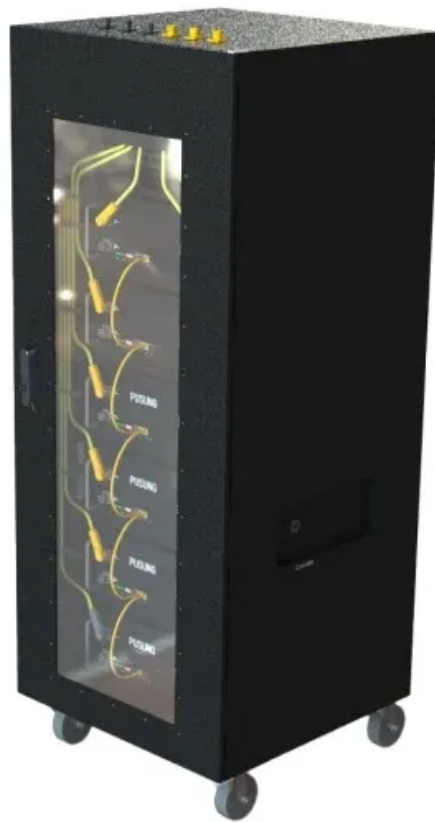



Overview

What are the dimensions of a residential solar panel?

Therefore, understanding these dimensions is essential for effective planning and installation. Residential solar panels are generally smaller to fit the limited roof space of a home. Common dimensions are approximately 65 x 39 inches.

How big should a commercial solar panel be?

For commercial solar panel installations, panels often range from 400W to 600W, with dimensions of approximately 195 x 99 x 3.81 cm (6.40 x 3.25 x 0.13 feet). Several factors affect the size of a solar panel, including the type of solar cells used, the desired wattage output, your property's size and the panel's overall efficiency.

How much does a solar panel weigh?

Below is a range of solar panel sizes. The 50W solar panel measures 670*540*25mm and weighs 20kg. The 100W solar panel has dimensions of 1030*460*30mm and weighs 20.3kg. The size of 200W solar panel is 1480*680*35mm, weight is 20.5kg.

How big is a solar panel in the UK?

Solar panel sizes in the UK are generally between 250W and 450W for domestic installations, with physical dimensions typically measuring around 189 x 100 x 3.99 cm (6.2 x 3.28 x 0.13 feet). For commercial solar panel installations, panels often range from 400W to 600W, with dimensions of approximately 195 x 99 x 3.81 cm (6.40 x 3.25 x 0.13 feet).

What are 96 unit solar panels?

The 96-unit solar panels have a structure of 8*12, and their dimensions are 2200*1100mm. 96-unit solar panels have a larger size, and their power is also larger, about 600W or more, and generally solar panels of this size will only be used in large-scale power stations.



How much wattage does a solar panel take?

Solar panel sizes and wattage range from 250W to 450W, taking up 1.6 to 2 square metres per panel. One of the most important things to consider when getting solar panels for your home is the specific solar panel size and dimensions.



Size of solar panels in mm



[What are the Standard Sizes of Solar Photovoltaic ...](#)

This article covers the standard sizes of solar photovoltaic panels and explains how to determine how many panels your solar system needs. It also helps estimate the system's capacity, annual energy production, and potential savings.

[A Beginner's Guide To Solar Panels: Size and ...](#)

How Much Do Solar Panels Weigh? Knowing the size of a residential solar panel, you may wonder how much a solar panel weighs. Will your roof be strong enough to support a solar system big enough to power your house? A residential solar ...



- ✓ TELECOM CABINET
- ✓ BRAND NEW ORIGINAL
- ✓ HIGH-EFFICIENCY

[How is the size of a solar panel calculated?](#)

At this point, the most important query is how much room is needed to install a 1 kW (kilowatt) solar panel. The explanation for that is that if a 24 V solar panel is chosen for the 1 kW power generation category, two ...

[Standard Solar Panel Sizes, and Dimensions \(2025\)](#)

Choosing the right solar panel size for your home involves a few considerations. These include power output, physical dimensions, and weight



to ensure optimal energy generation. The average domestic solar panel outputs ...



[Solar Cable Sizing Guide How Solar PV Cables Work...](#)

The solar panels generate electricity which has to be transferred elsewhere - this is where solar cables come in. The biggest distinction in terms of size is between solar cable 4mm and solar cable 6mm.

[Solar Panel Dimensions and Sizes: Complete Guide](#)

Standard Solar Panel Size How big is a solar panel? There are three main sizes of solar panels to know: 60-cell, 72-cell, and 96-cell. For commercial and residential solar panels, the 60-cell and 72-cell solar panels size are most ...

18650^{3.7V}
Li-ion
RECHARGEABLE BATTERY
2000mAh



[Complete guide to solar panel size and weigh](#)

The 96-unit solar panels have a structure of 8*12, and their dimensions are 2200*1100mm. 96-unit solar panels have a larger size, and their power is also larger, about 600W or more, and generally solar panels of this ...



[We Analyzed 100 Solar Panels: Dimensions, ...](#)

The most common depth is 1.38 inches. Panel dimensions are influenced by wattage, cell technology, and panel design, which means sizes will always vary, even between panels with similar wattage or efficiency ratings. Understanding ...



[How Big Are Solar Panels? 2025 Definitive Guide](#)

The average solar panel size is 165.1 x 99.06 centimeters or 5.41 x 3.25 feet or 65 x 39 inches or 1651 x 990.6 millimeters or 1.65 x 0.99 meters, depending on whether it is for commercial or residential uses. The ...



[Solar Panel Size in Australia: How Many Solar Panels ...](#)

Solar panel size or dimension determines the number of solar panels required in Australia and their wattage, measured in height by width. And the solar system produces the wattage, measured in Watts or W.



[How to Calculate Size of a Solar Panel? Convert \(mm\)](#)

It is always a tough task to find the accurate information about the product that we want use, with solar panels it is always difficult to get the actual size (dimensions) of a solar panel and to understand them properly in ...

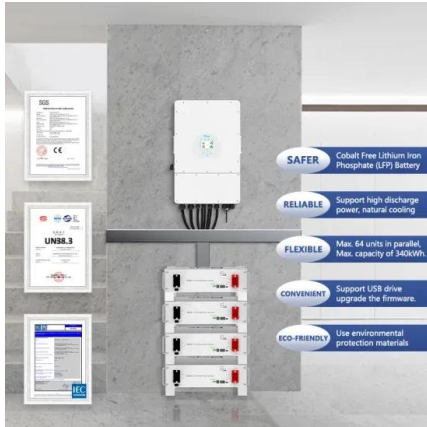

[Solar Panel Sizes & Dimensions \(SA\): Simply ...](#)

Solar panel dimensions & sizes (SA): Simply explained When it comes to investing in solar energy, choosing the right solar panel size is bottom-line. Indeed, it's not just about finding something that fits your roof. The size of your ...

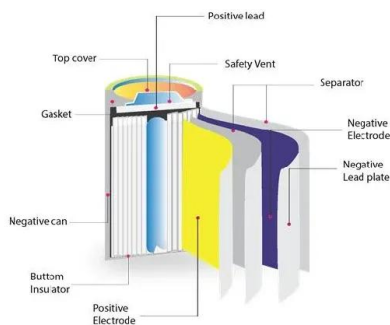

[How Big Is A Solar Panel? Dimensions And Sizes](#)

Solar panels come in various shapes and sizes, offering an array of dimensions tailored to meet diverse energy needs. These photovoltaic marvels, harnessing sunlight to generate power, present an intricate blend of ...

[Solar Panel Size & Weight Guide \[+ Charts\] - Solartap](#)

Solar panel dimensions depend on how many cells are in each panel, as cell size is pretty uniform across all brands of residential solar panels. Each cell is usually 156 millimeters by 156 millimeters, or 6 inches long and 6 ...





[Solar Panel Sizes And Wattage , Sizing Dimensions...](#)

The size or dimensions of the solar panels, measured in height by width, will determine the number of solar panels that will fit on your roof and the wattage of solar panels installed. And the power produced or wattage ...

[Solar Cell Size: The Ultimate Guide to Choosing the ...](#)

Introduction: Understanding Solar Cell Sizes Solar cell size can vary depending on the type of cell and its intended application. Standard solar panels for residential use typically have 60 cells, each measuring about 156 ...



Contact Us

For catalog requests, pricing, or partnerships, please visit:
<https://solar360.co.za>